

TCR

400 °C/2h and 300 °C/2h centrifugal extractor fans with backward curved impeller

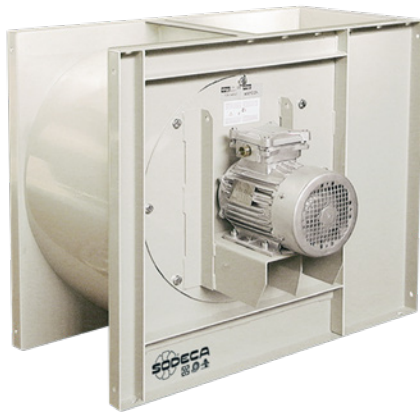

Extremely robust 400 °C/2h medium pressure single inlet centrifugal extractor fans with backward curved impeller for immersed operation in fire risk zones.

Fan:

- Sheet steel casing.
- Backward curved impeller in very robust sheet steel, with anti-heat paint.
- Approved in accordance with standard EN 12101-3, with certificate no.: 0370-CPR- 0384.

Motor:

- Motors with IE3 efficiency for powers equal to or greater than 0.75 kW, except single-phase, 2-speed and 8-pole.

- Class H motors for S1 continuous operation and S2 emergency use. With ball bearings and IP55 protection.
- Three-phase 230/400 V 50 Hz (up to 3 kW) and 400/690 V 50 Hz (powers greater than 3 kW).
- Maximum temperature of air to be carried: S1 continuous operation -25 °C +120 °C. S2 operation, 300 °C/2h and 400 °C/2h.

Finish:

- Anti-corrosive finish in polyester resin, polymerised at 190 °C, after degreasing with phosphate-free nanotechnology treatment.

Order code

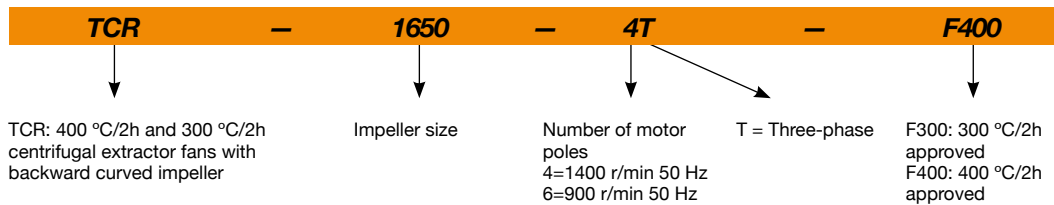

Orientations

Standard supply LG 270

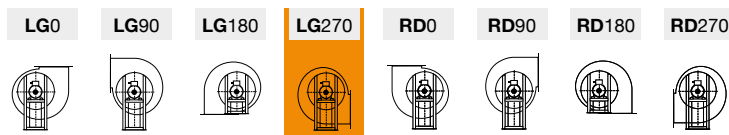

Technical characteristics

Model	Speed (r/min)	Maximum admissible current (A)			Installed power (kW)	Maximum flow rate (m³/h)	Sound pressure level¹ dB (A)	Approx. weight (Kg)
		230V	400V	690V				
TCR-1240-4T IE3	1425	3.08	1.79		0.75	5830	65	76
TCR-1445-4T IE3	1435	4.10	2.37		1.10	8100	68	98
TCR-1650-4T IE3	1140	5.89	3.38		1.50	10600	70	118
TCR-1650-6T IE3	950	3.36	1.93		0.75	7410	60	118
TCR-1856-4T IE3	1455	11.01	6.33		3.00	15240	76	158
TCR-1856-6T IE3	950	4.73	2.72		1.10	10050	68	150
TCR-2063-4T IE3	1465		10.40	6.04	5.50	24490	78	257
TCR-2063-6T IE3	955	6.25	3.62		1.50	16100	68	212
TCR-2271-4T IE3	1480		20.70	11.99	11.00	34760	84	380
TCR-2271-6T IE3	970	12.80	6.36		3.00	23010	75	313

¹ Irradiated sound pressure level in dB(A) at a distance of 3 m.



Erp. (Energy Related Products)

Information on Directive 2009/125/EC can be downloaded from the SODECA website or the QuickFan selector programme.

Acoustic characteristics

Irradiated sound power spectrum Lw(A) in dB(A) per Hz frequency band

	63	125	250	500	1000	2000	4000	8000		63	125	250	500	1000	2000	4000	8000
TCR-1240-4T	53	67	73	76	76	77	67	56	TCR-1856-6T	58	66	78	80	77	78	68	57
TCR-1445-4T	56	69	75	80	77	80	75	61	TCR-2063-4T	77	82	88	90	88	85	78	70
TCR-1650-4T	61	71	79	81	80	82	73	63	TCR-2063-6T	66	67	79	79	78	80	70	60
TCR-1650-6T	50	62	69	74	70	66	59	51	TCR-2271-4T	80	81	90	93	95	96	92	79
TCR-1856-4T	66	75	88	84	87	88	82	68	TCR-2271-6T	70	70	84	83	87	87	76	65

Dimensions mm

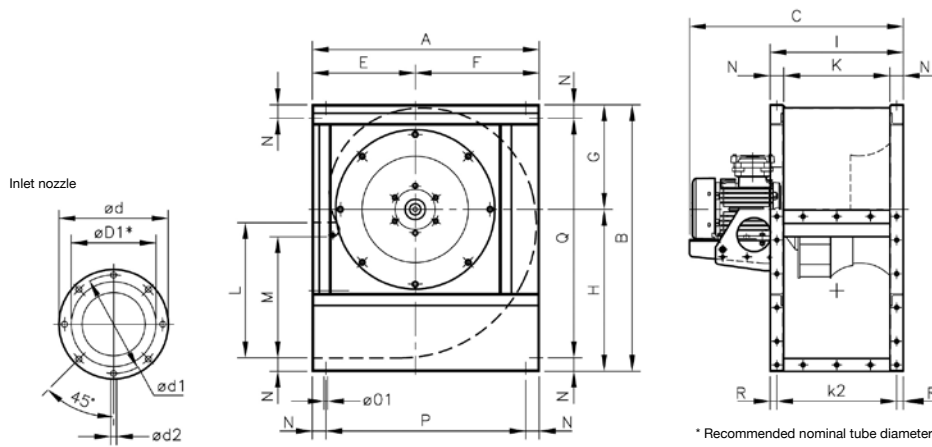

	A	B	C	Ød	Ød1	ØD1*	Ød2	E	F	G	H	M	N	Ø01	P	Q	R
TCR-1240-4T	673	790	634	472	444	400	M8	305	368	310	480	358.5	40	11	593	710	20
TCR-1445-4T	765	880	727	522	494	450	M8	350	415	339	541	407	45	11	675	790	20
TCR-1650-4T	832	970	770.5	582	555	500	M10	375	457	378	592	445	45	13	742	880	20
TCR-1650-6T	832	970	770.5	582	555	500	M10	375	457	378	592	445	45	13	742	880	20
TCR-1856-4T	925	1084	857.5	645	615	560	M10	415	510	424	660	493	50	13	825	984	25
TCR-1856-6T	925	1084	828	645	615	560	M10	415	510	424	660	493	50	13	825	984	25
TCR-2063-4T	1037	1218	955	720	688	630	M10	465	572	477	741	530	60	13	917	1098	30
TCR-2063-6T	1037	1218	932	720	688	630	M10	465	572	477	741	530	60	13	917	1098	30
TCR-2271-4T	1173	1375	1149	800	768	710	M12	525	648	538	837	603.5	65	13	1043	1245	32.5
TCR-2271-6T	1173	1375	1112	800	768	710	M12	525	648	538	837	603.5	65	13	1043	1245	32.5

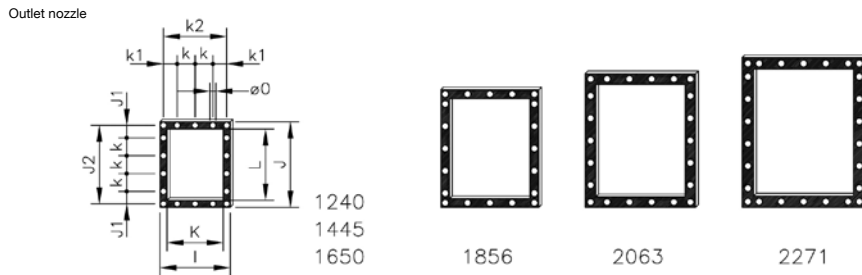

	I	J	J1	J2	K	k	k1	k2	L	Ø0
TCR-1240	395	480	70	440	315	100	77.5	355	400	11
TCR-1445	445	540	99	498	355	100	102.5	405	450	11
TCR-1650	490	590	87.5	550	400	125	100	450	500	13
TCR-1856	550	660	55	610	450	125	125	500	560	13
TCR-2063	620	750	95	690	500	125	92.5	560	630	13
TCR-2271	690	840	75	775	560	125	62.5	625	710	13

Characteristic curves

Q= Flow rate in m³/h, m³/s and cfm

Pe= Static pressure in mm H₂O, Pa and inwg

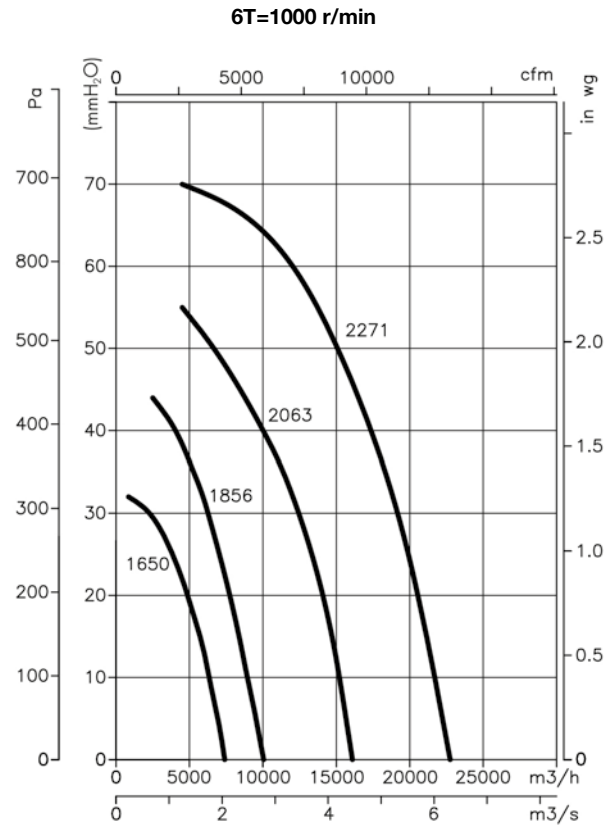
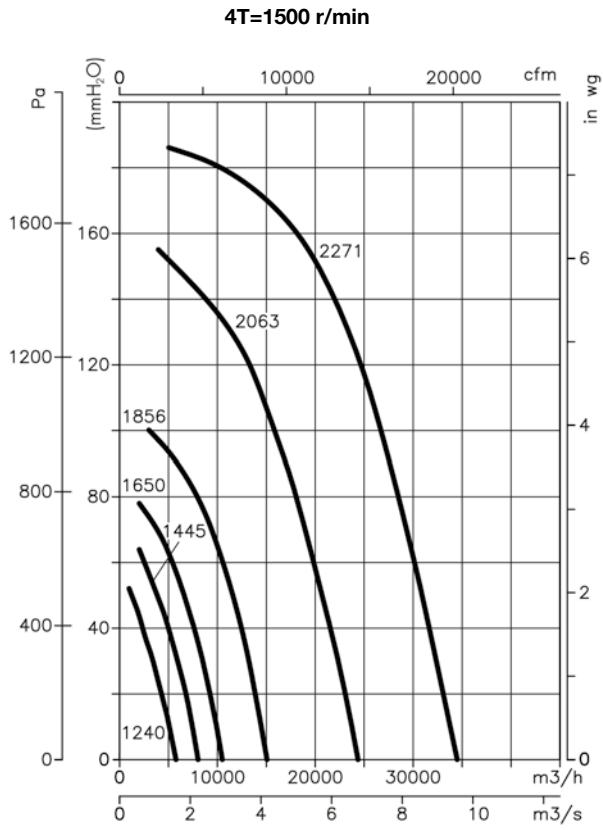

Accessories



INT



IAT



C2V



RPA



B



BD



BIC



ACE ACE/400



CABLE BOX



AET



CENTRAL CO



VSD3/A-RFT
- VSD1/A-RFM