



SVE SVE/PLUS

SVE: Low-noise, in-line duct extractor fans mounted inside an acoustic casing.

SVE/PLUS: Low-noise, in-line duct extractor fans mounted inside an acoustic casing with 40 mm phonoabsorbent insulation.



SVE



SVE/PLUS: Fitted with a folding inspection cover, except models 100-125-150/L-160/L

Fan:

- Acoustic casing coated with phonoabsorbent material.
- Impeller with reaction blades except models 100-125-150-160-200/H, with multi-blade impeller.
- Standardised inlet and impulsion flanges allowing for easy installation in ducts.
- Fitted with a folding inspection cover, except models 100-125-160/L-150/L.
- Support feet built into the box, for easy installation.
- Linear airflow direction.

Motor:

- External rotor motors with built-in thermal protector, class F, with ball bearings, IP54 protection.
- Adjustable, single-phase 230 V 50 Hz/60 Hz.
- Maximum temperature of air to be carried: +50 °C.

Finish:

- Anti-corrosive finish on galvanised sheet steel.

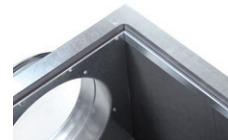

40 mm acoustic insulation model SVE/PLUS



S version with built-in switch

Order code

SVE/PLUS — 150/H — S

SVE: In-line duct extractor fans
 SVE/PLUS: In-line duct extractor fans with 40 mm insulation.

Nozzle diameter in mm

Flow rate
 H: High flow rate
 L: Low flow rate

Built-in off-on switch.

Technical characteristics

	Speed (r/min)	Maximum admissible current 230 V (A)	Max. electric power (kW)	Maximum flow rate (m ³ /h)	Irradiated sound level dB(A)	Approx. weight (kg)	Impeller type	According to ErP
SVE-100/L	1800	0.45	0.10	290	30	5.5	Forward	2018
SVE-125/H	2340	0.75	0.18	370	41	6	Forward	2018
SVE-125/L	1800	0.45	0.10	310	31	5.5	Forward	2018
SVE-150/H	2250	1.00	0.25	490	40	7	Forward	2018
SVE-150/L	1800	0.45	0.10	355	30	6	Forward	2018
SVE-160/H	2250	1.00	0.25	490	40	7	Forward	2018
SVE-200/H	1400	0.75	0.18	760	42	12	Forward	2018
SVE-200/L	2650	0.70	0.18	665	41	9	Backward	2018
SVE-250/H	2400	0.75	0.18	1140	49	11	Backward	2018
SVE-250/L	2750	0.75	0.17	684	41	9.5	Backward	2018
SVE-315/H	1400	0.65	0.14	1150	46	17.5	Backward	2018
SVE-350/H	1400	0.85	0.20	1524	44	21.5	Backward	2018
SVE-400/H	1350	1.20	0.30	1957	46	27	Backward	2018

Technical characteristics

	Speed (r/min)	Max. admissible current 230 V (A)	Max. electric power (kW)	Max. flow rate (m ³ /h)	Irradiated sound level dB(A)	Approx. weight (kg)	Type of impeller	According to ErP
SVE/PLUS-100/L	1800	0.45	0.10	290	27	9	Forward	2018
SVE/PLUS-125/H	2340	0.75	0.18	370	38	9.5	Forward	2018
SVE/PLUS-125/L	1800	0.45	0.10	310	28	9	Forward	2018
SVE/PLUS-150/H	2250	1.00	0.25	490	36	12	Forward	2018
SVE/PLUS-150/L	1800	0.45	0.10	355	26	9.5	Forward	2018
SVE/PLUS-160/H	2250	1.00	0.25	490	36	12	Forward	2018
SVE/PLUS-160/L	1800	0.45	0.10	355	26	9.5	Forward	2018
SVE/PLUS-200/H	1400	0.75	0.18	760	38	16.5	Forward	2018
SVE/PLUS-200/L	2650	0.7	0.18	640	37	13.5	Backward	2018
SVE/PLUS-250/H	2400	0.75	0.18	1140	44	15	Backward	2018
SVE/PLUS-250/L	2750	0.75	0.17	705	36	14	Backward	2018
SVE/PLUS-315/H	1400	0.65	0.14	1315	41	23	Backward	2018
SVE/PLUS-350/H	1400	0.85	0.20	1555	38	29.5	Backward	2018
SVE/PLUS-400/H	1350	1.20	0.30	2310	41	33	Backward	2018



Erp. (Energy Related Products)

Information on Directive 2009/125/EC can be downloaded from the SODECA website or the QuickFan selector programme.

Acoustic characteristics

The values given are determined by measuring the sound power in dB(A) obtained in a free field at a distance equivalent to twice the size of the fan plus the impeller diameter, with a minimum of 1.5 m.

SVE

Sound power spectrum Lw(A) in dB(A) per Hz frequency band.

	63	125	250	500	1000	2000	4000	8000
SVE-100/L	23	31	36	35	34	35	31	25
SVE-125/H	23	33	37	35	34	35	31	25
SVE-125/L	21	31	32	34	35	36	32	26
SVE-150/H	33	43	47	45	44	45	41	35
SVE-150/L	31	41	42	44	45	46	42	36
SVE-160/H	31	41	42	44	45	46	42	36
SVE-200/H	28	39	46	47	47	45	42	33

	63	125	250	500	1000	2000	4000	8000
SVE-200/L	29	40	47	48	48	46	43	34
SVE-250/H	27	37	42	48	47	46	43	35
SVE-250/L	35	45	50	56	55	54	51	43
SVE-315/H	30	40	45	52	53	51	48	39
SVE-350/H	29	39	43	50	51	49	47	38
SVE-400/H	32	42	46	53	54	52	50	41

SVE/PLUS

Sound power spectrum Lw(A) in dB(A) per Hz frequency band.

	63	125	250	500	1000	2000	4000	8000
SVE/PLUS-100/L	20	31	34	30	25	29	27	24
SVE/PLUS-125/H	30	43	45	40	35	39	37	34
SVE/PLUS-125/L	20	33	35	30	25	29	27	24
SVE/PLUS-150/H	28	41	40	39	36	40	38	35
SVE/PLUS-150/L	18	31	30	29	26	30	28	25
SVE/PLUS-160/H	28	41	40	39	36	40	38	35
SVE/PLUS-160/L	18	31	30	29	26	30	28	25

	63	125	250	500	1000	2000	4000	8000
SVE/PLUS-200/H	26	40	45	43	39	40	39	33
SVE/PLUS-200/L	25	39	44	42	38	39	38	32
SVE/PLUS-250/H	32	45	48	51	46	48	47	42
SVE/PLUS-250/L	24	37	40	43	38	40	39	34
SVE/PLUS-315/H	27	40	43	47	44	45	44	38
SVE/PLUS-350/H	26	39	41	45	42	43	43	37
SVE/PLUS-400/H	29	42	44	48	45	46	46	40

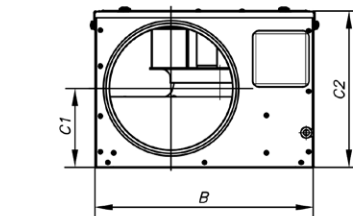
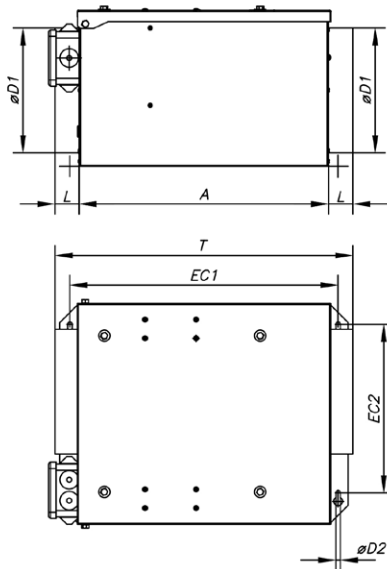
Dimensions mm
SVE

	A	B	C1	C2	øD1	L	øD2	EC1	EC2	T
SVE-100/L	300	265	82.5	180	100	36	7	330	205	372
SVE-125/L	300	265	80.5	180	125	36	7	330	205	372
SVE-125/H	300	265	80.5	180	125	36	7	330	205	372
SVE-150/L	300	265	88.5	180	150	40	7	330	205	380
SVE-150/H	300	260	100	195	150	40	7	330	190	380
SVE-160/H	300	260	100	195	160	40	7	330	190	380
SVE-200/L	400	350	127	250	200	40	7	430	270	480
SVE-200/H	400	350	127	250	200	40	7	430	270	480
SVE-250/L	400	350	142	290	250	48	7	430	280	496
SVE-250/H	400	350	142	290	250	48	7	430	280	496
SVE-315/H	515	480	175	355	315	48	7	545	405	610
SVE-350/H	575	545	211.5	410	350	58	7	605	445	690
SVE-400/H	650	610	230	455	400	74	7	680	520	800

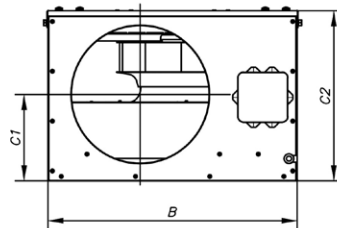
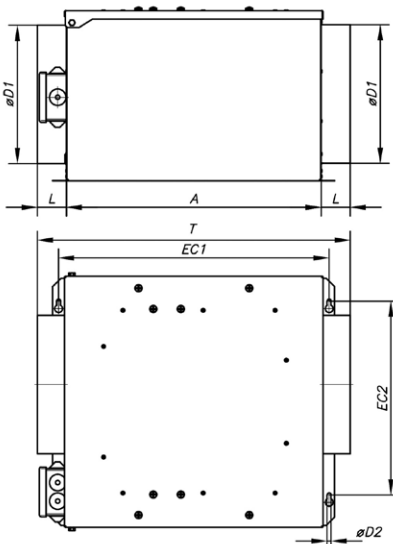
SVE/PLUS

	A	B	C1	C2	øD1	L	øD2	EC1	EC2	T
SVE/PLUS-100/L	380	350	100	230	100	35	7	410	290	450
SVE/PLUS-125/L	380	350	100	230	125	35	7	410	290	450
SVE/PLUS-125/H	380	350	100	230	125	35	7	410	290	450
SVE/PLUS-150/L	380	350	110	230	150	35	7	410	290	450
SVE/PLUS-160/L	380	350	110	230	160	35	7	410	290	450
SVE/PLUS-150/H	380	335	165	265	150	37.5	7	405	265	455
SVE/PLUS-160/H	380	335	165	265	160	37.5	7	405	265	455
SVE/PLUS-200/L	460	450	162	285	200	37.5	7	490	380	535
SVE/PLUS-200/H	460	450	162	285	200	37.5	7	490	380	535
SVE/PLUS-250/L	460	450	156	310	250	52.5	7	490	380	565
SVE/PLUS-250/H	460	450	156	310	250	52.5	7	490	380	565
SVE/PLUS-315/H	565	540	210	390	315	57.5	9	595	440	680
SVE/PLUS-350/H	650	600	233.5	435	350	57.5	9	680	525	765
SVE/PLUS-400/H	650	680	263.5	500	400	77.5	9	680	600	805

Characteristic curves

Q= Flow rate in m³/h, m³/s and cfm

Pe= Static pressure in mmH₂O, Pa and inwg

**SVE
SVE/PLUS**

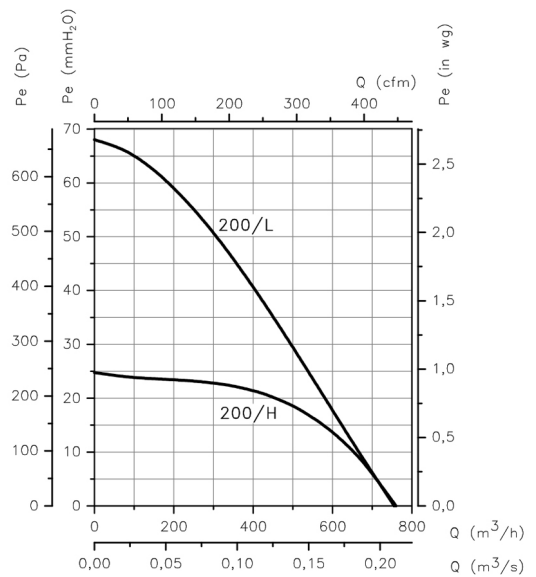
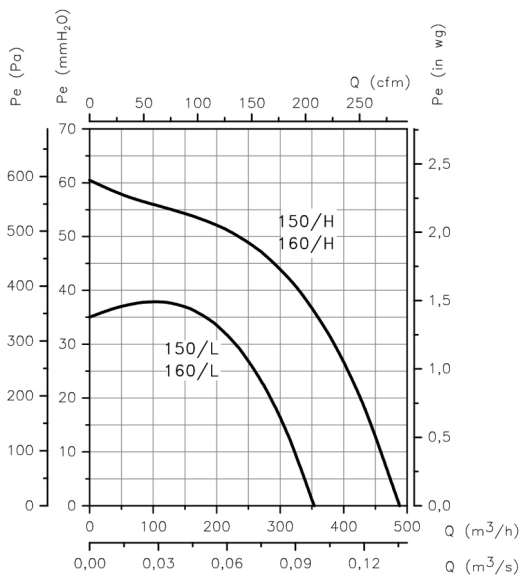
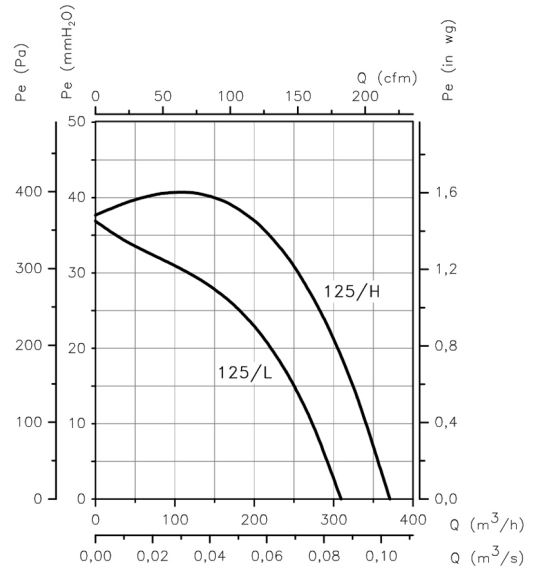
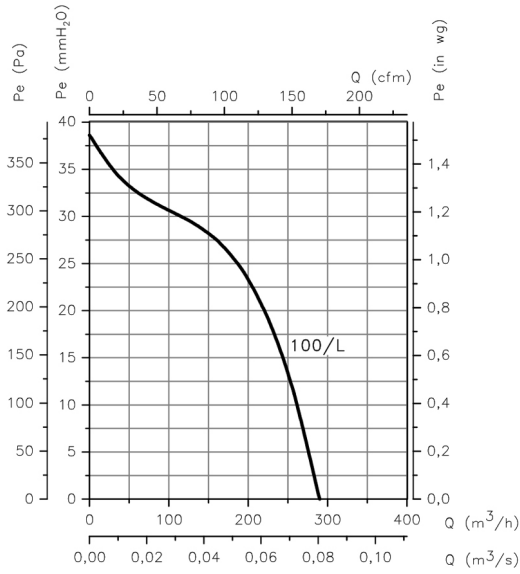

Characteristic curves

 Q= Flow rate in m³/h, m³/s and cfm

 Pe= Static pressure in mmH₂O, Pa and inwg

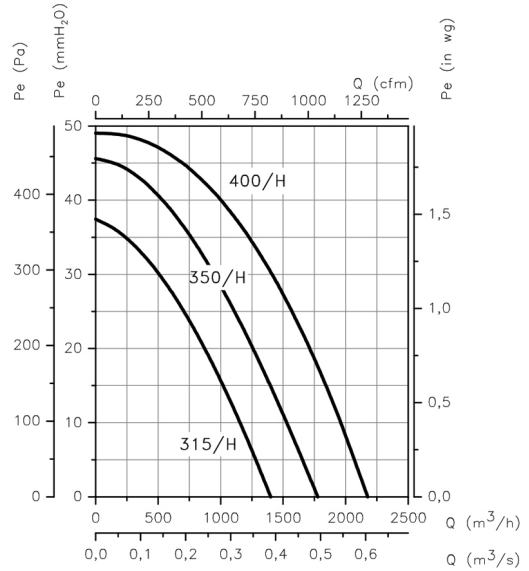
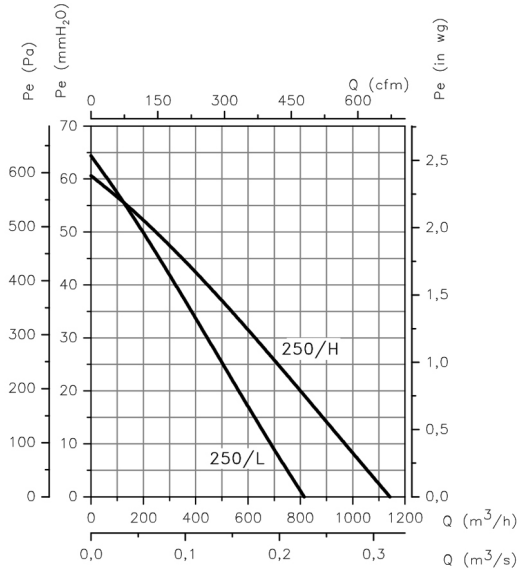
**SVE
SVE/PLUS**

Accessories

Recommended accessories

SI-HUMIDITY sensor	RMC	SV/SVE PLUS EC
SI CO2 sensor	RMC	SV/SVE PLUS EC
SI MF sensor (HUMIDITY + CO2)	RMC	SV/SVE PLUS EC
SI-PIR sensor	RMC	SV/SVE PLUS EC
SI-PIR	RM	SV/SVE PLUS AC

Accessories recommended to comply with ErP 2018