



AIRTECHNIC

www.airtechnic.gr

Air-Conditioning & Ventilation Components & Systems

● SINGLE INLET CENTRIFUGAL FANS

περισσότερα
learn more



 www.airtechnic.gr

 www.facebook.com/Airtechnic.gr

 www.instagram.com/airtechnic.chatzoudis

V. 4

SINGLE INLET CENTRIFUGAL FANS

max. **16.000** m³/h

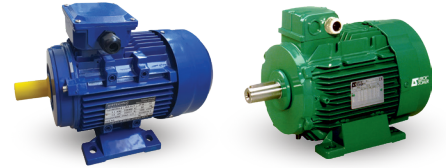

TECHNICAL CHARACTERISTICS

- Low & medium pressure fans, manufactured by **AIRTECHNIC** with CE certification. Shell made of galvanized steel sheet. **IP55**, class **F** motors.
- Suitable for ventilation of **rotisseries**, **professional kitchens**, industrial areas, paint shops etc.
- Impeller dynamically and statically balanced, with **sparse spoon-shaped fins** for easy cleaning, preventing the accumulation of greasy residues, thus increasing its lifespan.

- Available models with **Sirocco type** impeller, dynamically and statically balanced.
- Speed can be adjust by REB-01 at 230V & INVERTER at 400V.
- It is possible (with extra charge) to choose a simple or explosion-proof **ABB**, **SIEMENS** or **EMERSON** motor.

| POWER HP | INLET GRILLE Ø mm | AIR FLOW m ³ /h | FAN SECTION WEIGHT  | FAN SECTION DIMENSIONS cm HEIGHT x WIDTH x LENGTH | | | | | |
|---------------------|-------------------------|----------------------------------|---|---|-------|-------|---------------------|-----|-----|
| | | | | AIR SUPPLY UP | | | AIR SUPPLY FRONT | | |
| | | | | H | W | L | H | W | L |
| 1.450 R.P.M. | | | | | | | | | |
| 0,5 | 200 | 2.700 | 44 | 62 | 64 | 64 | 72 | 70 | 64 |
| 1 | 250 | 5.000 | 50 | 71 | 71 | 79 | 90 | 70 | 70 |
| 1,5 | | 6.000 | 56 | 71 | 71 | 79 | 90 | 70 | 70 |
| 2 | 300 | 8.000 | 74 | 82 | 82 | 91 | 100 | 82 | 82 |
| 3 | | 9.000 | 78 | 82 | 82 | 91 | 100 | 82 | 82 |
| 3 | 350 | 9.000 | 81 | 82 | 86 | 95 | 110 | 86 | 85 |
| 4 | | 11.000 | 92 | 90 | 86 | 100 | 110 | 85 | 85 |
| 5,5 | 450 | 13.000 | 100 | 90 | 86 | 100 | 115 | 90 | 90 |
| 7,5 | | 14.500 | | 115 | 115 | 111 | 123,5 | 115 | 115 |
| 950 R.P.M. | | | | | | | | | |
| 0,5 | 250 | 4.000 | | 71 | 71 | 79 | 90 | 70 | 70 |
| 1 | 300 | 6.000 | | 82 | 82 | 91 | 100 | 75 | 80 |
| 1,5 | | 8.000 | | 82 | 82 | 91 | 100 | 75 | 80 |
| 2 | 350 | 10.000 | | 90 | 86 | 100 | 115 | 90 | 90 |
| 3 | | 11.000 | | 90 | 86 | 100 | 115 | 90 | 90 |
| 4 | 450 | 12.500 | | 114 | 117,1 | 117,1 | 123,5 | 115 | 115 |
| 5,5 | | 16.000 | | 114 | 117,1 | 117,1 | 123,5 | 115 | 115 |

AIR INLET ON THE RIGHT or THE LEFT SIDE

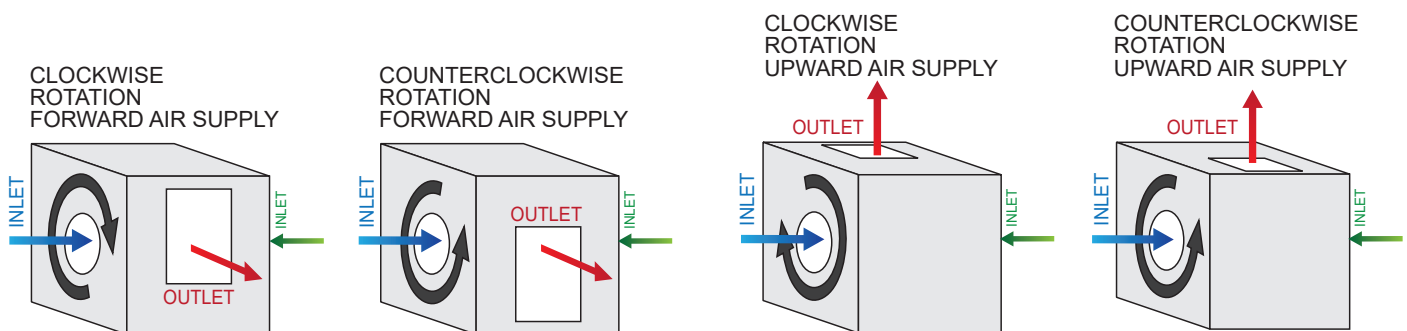

1.450 / 950 R.P.M. FANS - DIMENSIONS (mm)

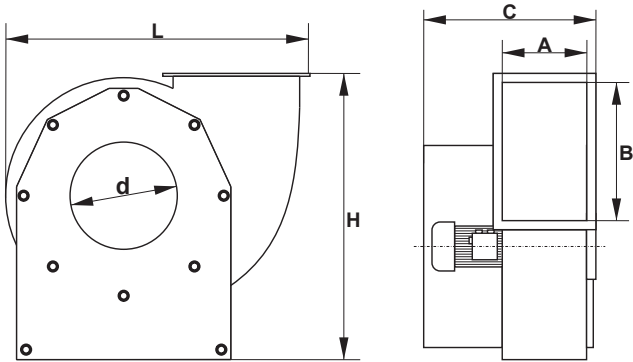

| MOTOR POWER HP | A | B | C | H | L | Ø mm |
|--------------------------|-----|-----|-----|-----|-------|------|
| 1.450 R.P.M. FANS | | | | | | |
| 0,5 | 205 | 240 | 485 | 470 | 555 | 200 |
| 1,0 | 225 | 335 | 545 | 585 | 685 | 250 |
| 1,5 | 260 | 335 | 590 | 585 | 685 | 250 |
| 2,0 | 275 | 390 | 625 | 675 | 815 | 300 |
| 3,0 | 275 | 390 | 625 | 675 | 815 | 300 |
| 3,0 - Ø350 | 325 | 395 | 720 | 675 | 815 | 350 |
| 4,0 | 325 | 445 | 750 | 765 | 905 | 350 |
| 5,5 | 325 | 445 | 750 | 765 | 905 | 350 |
| 7,5 | 430 | 570 | 950 | 935 | 1.030 | 450 |

| MOTOR POWER HP | A | B | C | H | L | Ø mm |
|------------------------|-----|-----|-----|-----|-------|------|
| 950 R.P.M. FANS | | | | | | |
| 0,5 | 225 | 335 | 545 | 585 | 685 | 250 |
| 1,0 | 275 | 390 | 625 | 675 | 815 | 300 |
| 1,5 | 275 | 390 | 625 | 675 | 815 | 300 |
| 2,0 | 325 | 445 | 750 | 765 | 905 | 350 |
| 3,0 | 325 | 445 | 750 | 765 | 905 | 350 |
| 4,0 | 430 | 570 | 950 | 935 | 1.030 | 450 |
| 5,5 | 430 | 570 | 950 | 935 | 1.030 | 450 |

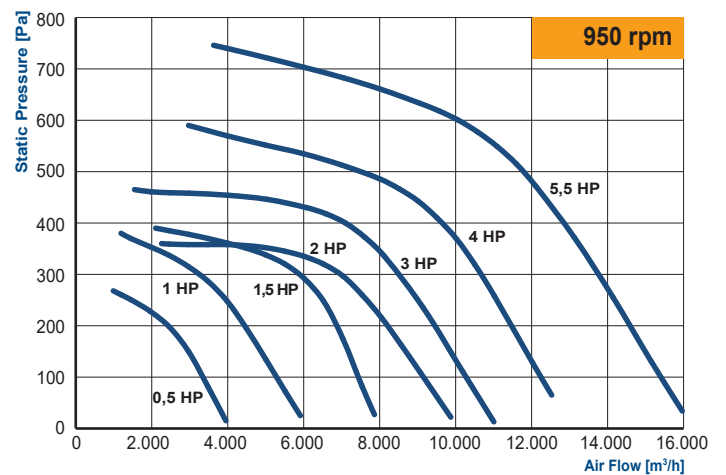
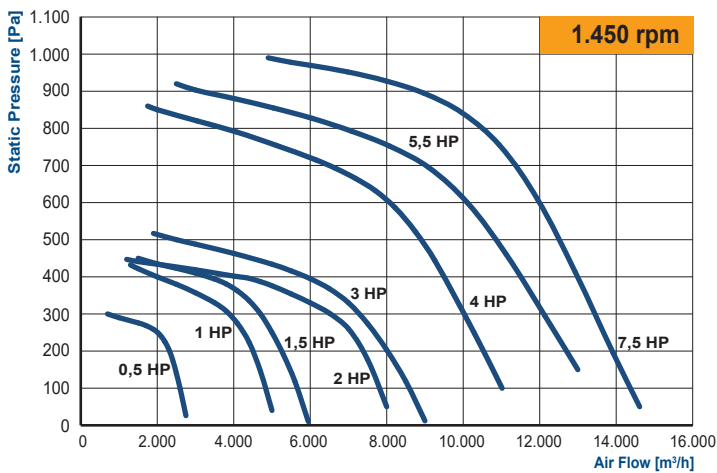

LG 0



RD 0

LG 90

RD 90

LG 270

RD 270

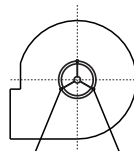
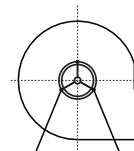
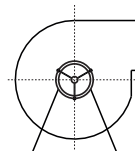
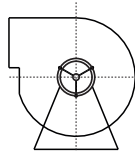
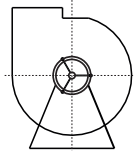
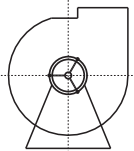



ISO 9001:2015



ISO 14001:2015

Management System
ISO 14001:2015
Valid until:
2024-05-24



www.tuv.com
ID: 9108660718

AIR HANDLING UNITS



HEAT EXCHANGERS



FAN COIL UNITS



FANS & FAN SECTIONS



FIRE DAMPERS



AIR OUTLETS



STEAM HUMIDIFIERS - DEHUMIDIFIERS



CENTRAL VACUUM SYSTEMS



TUBO
THINK CLEAN

STAINLESS STEEL CHIMNEYS



AIR FILTERS



AIR CURTAINS



EVAPORATIVE COOLING



Main Office ATHENS

📍 Paparrigopoulou 10 & Lagada,
12132, Peristeri, Athens

211 - 705.55.00

✉ sales@airtechnic.gr

Factory - THIVA

📍 4th km Thiva - Chalkida Hwy,
32200, Thiva

22620 - 89.006

✉ factory@airtechnic.gr

Factory - THESSALONIKI

📍 End of Meandrou Str.,
57013, Oraiokastro, Thessaloniki

2311 - 82.40.00

✉ thessaloniki@airtechnic.gr