



**AIRTECHNIC**

www.airtechnic.gr

Air-Conditioning & Ventilation Components & Systems

# ANEMIΣΤΗΡΕΣ IN LINE

## SEG & SEG EC SERIES

### IN LINE FANS

360 ÷ 2.200  
m<sup>3</sup>/h



[www.airtechnic.gr](http://www.airtechnic.gr)



[www.facebook.com/Airtechnic.gr](https://www.facebook.com/Airtechnic.gr)



# SEG EC Series

## Mixed Flow Inline Duct Fans with EC motors

- ◆ EC motors, with speed control, for extremely low power consumption.
- ◆ Construction from environmentally friendly material, of high aesthetics, low weight and double insulation.
- ◆ Specially designed impeller to achieve optimum air supply and pressure, high efficiency and low noise level.
- ◆ Operating Voltage 230V.
- ◆ High quality bearings for a service life of over 50.000h.
- ◆ Operating temperature from -200C to +600C.
- ◆ Easy to install between air ducts.
- ◆ By placing 2 fans in parallel, we achieve twice the air flow with the same static pressure available.
- ◆ By placing 2 fans in a row, we achieve twice the available static pressure with the same air supply.



- ◆ External Control with ON / OFF Switch and Potentiometer or with BMS system.



**360 ÷ 2.200**  
**m<sup>3</sup>/h**



High quality impeller



Connection box IP44



Easy installation

**USE:**

In offices, workplaces, houses, hotels, hospitals, etc.

**UNDER REQUEST:**

Manufacture with additional functions such as timer, temperature or humidity sensor, etc.

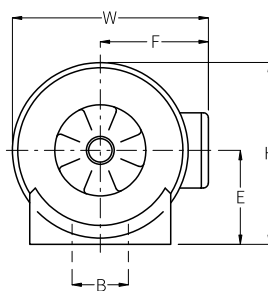
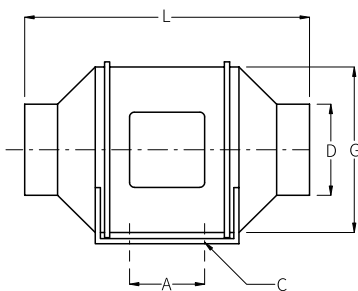
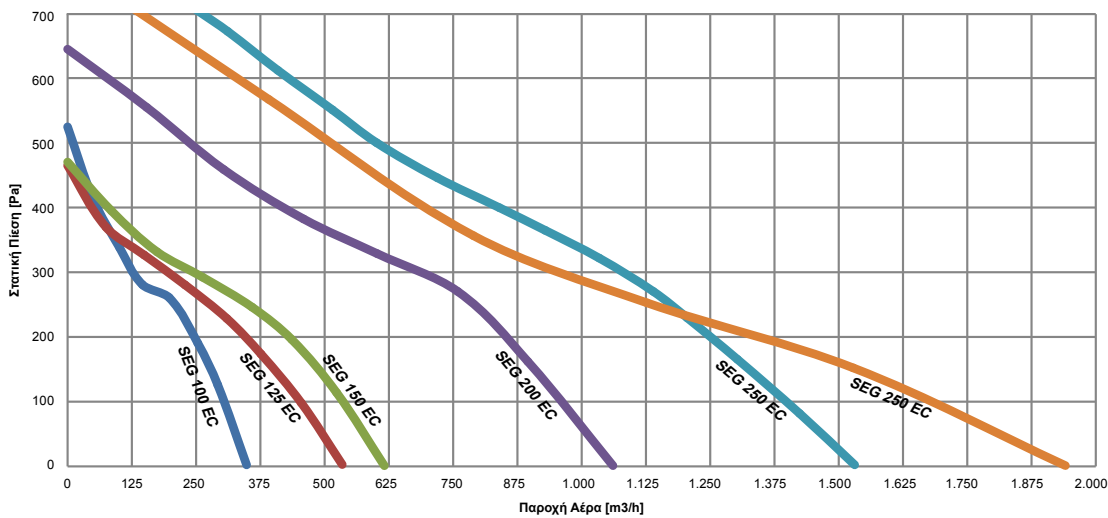

SIZE	AIR SUPPLY m <sup>3</sup> /h	NOISE LEVEL dB 3m	POWER W	DIMENSIONS mm			WEIGHT kg
				L	W	H	
SEG SILENT 100S EC	198	35	16,5	302	204	195	2,0
SEG SILENT 125S EC	284	35	17,5	257	204	195	1,8
SEG-100 EC	366	35	70	302	204	195	2,0
SEG-125 EC	561	35	70	257	204	195	1,8
SEG-150 EC	647	35	70	313	227	208	2,7
SEG-200 EC	1.250	50	165	302	249	237	4,9
SEG-250 EC	1.650	56	255	383	310	286	7,9
SEG-315 EC	2.206	55	250	446	386	357	11,3

# SEG Series

## Mixed Flow Inline Duct Fans with AC motors

**30 ÷ 2.200**  
**m<sup>3</sup>/h**

- ◆ Construction from environmentally friendly material, of high aesthetics, low weight and double insulation.
- ◆ Specially designed impeller to achieve optimum air supply and pressure, high efficiency and low noise level.
- ◆ Operating Voltage 230V.
- ◆ High quality bearings for a service life of over 50.000h.
- ◆ Operating temperature from -200C to +600C.
- ◆ Easy to install between air ducts.
- ◆ Type T has an adjustable timer of 1+30 min.
- ◆ By placing 2 fans in parallel, we achieve twice the air flow with the same static pressure available.
- ◆ By placing 2 fans in a row, we achieve twice the available static pressure with the same air supply.



**60°C**



High quality impeller



Connection box IP44



Easy installation

**USE:**

In offices, workplaces, houses, etc.

**ACCESSORIES:**

Plastic gravity grille, plastic grille with fixed blades, non-return damper, 2-speed & 3-speed switch, thermostat, humidifier & air quality sensor.

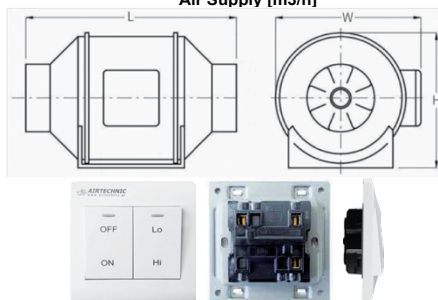
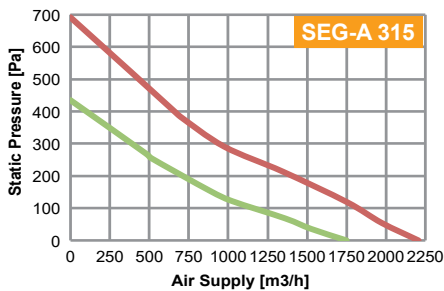
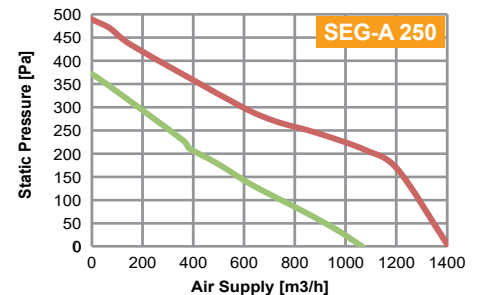
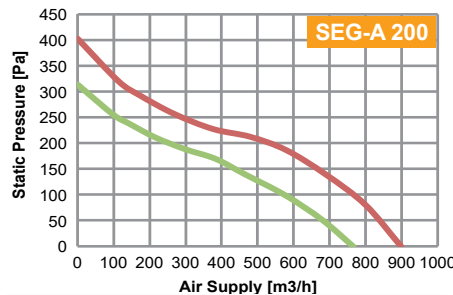
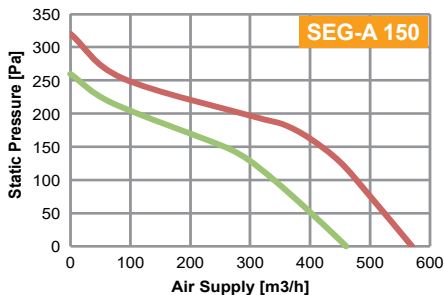
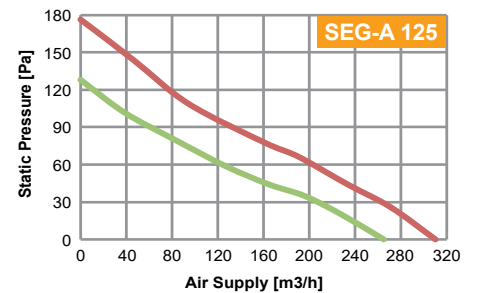
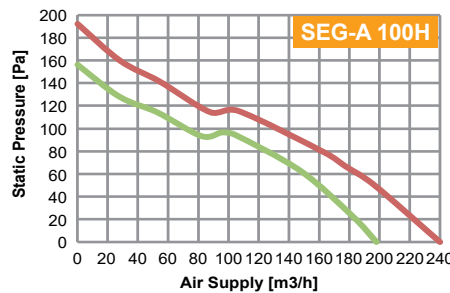
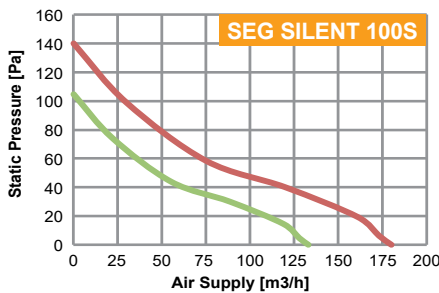

**2-SPEED SWITCH 2VBI (BUILT-IN)**



SIZE	AIR SUPPLY m <sup>3</sup> /h		NOISE LEVEL dBA 3m		POWER W		DIMENSIONS mm			WEIGHT kg
	Max	Min	Max	Min	Max	Min	L	W	H	
SEG SILENT 100S	180	133	31	26	40	20	246	188	160	1,3
SEG-A 100H	240	198	35	31	35	31	302	204	195	1,5
SEG-A 125	310	265	35	31	36	32	257	204	195	1,5
SEG-A 150	570	460	34	32	63	52	313	227	208	2,6
SEG-A 200	900	765	41	39	135	125	302	249	237	4,9
SEG-A 250	1.405	1.064	66	58	225	165	383	310	286	7,5
SEG-A 315	2.206	1.750	69	61	390	275	446	386	357	11

CONTROL OPTIONS | 2-Speed switch 2VBI (built-in) | 2-Speed switch DUO (wall-mounted) | 3-Speed switch RAB90



Management System  
ISO 14001:2015



www.tuv.com  
ID: 9108650718

ISO 9001:2015

ISO 14001:2015

## ΚΕΝΤΡΙΚΕΣ ΜΟΝΑΔΕΣ ΚΛΙΜΑΤΙΣΜΟΥ



## ΕΝΑΛΛΑΚΤΕΣ ΑΕΡΑ - ΑΕΡΑ



## FAN COIL UNITS

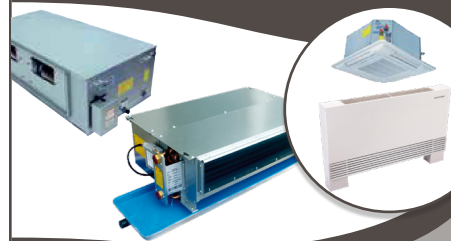

## ΑΝΕΜΙΣΤΗΡΕΣ & FAN SECTIONS

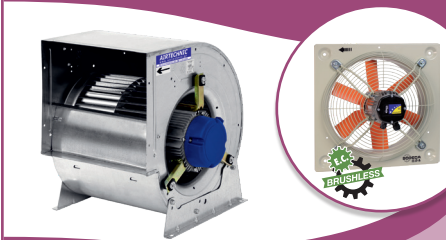

## ΔΙΑΦΡΑΓΜΑΤΑ ΠΥΡΚΑΓΙΑΣ

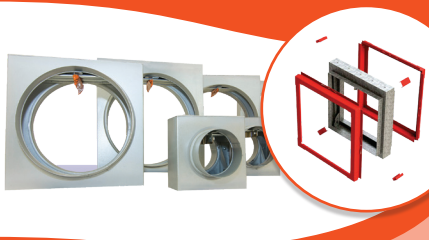

## ΣΤΟΜΙΑ ΑΕΡΑ



## ΥΓΡΑΝΤΗΡΕΣ ΑΤΜΟΥ - ΑΦΥΓΡΑΝΤΗΡΕΣ



## ΚΕΝΤΡΙΚΗ ΗΛΕΚΤΡΙΚΗ ΣΚΟΥΠΑ



ΤΥΒΟ  
THINK CLEAN

## ΑΝΟΞΕΙΩΤΕΣ ΚΑΜΙΝΑΔΕΣ



## ΦΙΛΤΡΑ



## ΑΕΡΟΚΟΥΡΤΙΝΕΣ



## ΔΡΟΣΙΣΜΟΣ



### ΕΔΡΑ - ΑΘΗΝΑ

📍 Μιχαήλ Καραολή 19,  
τ.κ.: 14343, Ν. Χαλκηδόνα Αθήνα  
211-7055500  
✉ sales@airtechnic.gr

### ΕΡΓΟΣΤΑΣΙΟ - ΘΗΒΑ

📍 4° χλμ. Θήβας - Χαλκίδας,  
τ.κ.: 32200, Θήβα  
22620 - 89006  
✉ factory@airtechnic.gr

### ΕΡΓΟΣΤΑΣΙΟ - ΘΕΣΣΑΛΟΝΙΚΗ

📍 Τέρμα προέκτασης Μαιάνδρου,  
τ.κ.: 57013, Ωραιόκαστρο Θεσ/νίκη  
2311 - 824000  
✉ thessaloniki@airtechnic.gr